

## 7.0 CLEANING INSTRUCTIONS

### ISOLATE FROM MAINS SUPPLY BEFORE CLEANING

- 1.0 The machine should be cleaned every day.
- 2.0 Empty filler hopper into a container and cover over for future use.  
**DO NOT TOP UP A HALF FULL CONTAINER.**
- 3.0 Wash outside of filler unit and the entire lid with a mild detergent/sanitiser and hot water.
- 4.0 Dismantle the pump unit at the base of the filler by removing the thumb screws (1) that hold the pump to the chamber (2).

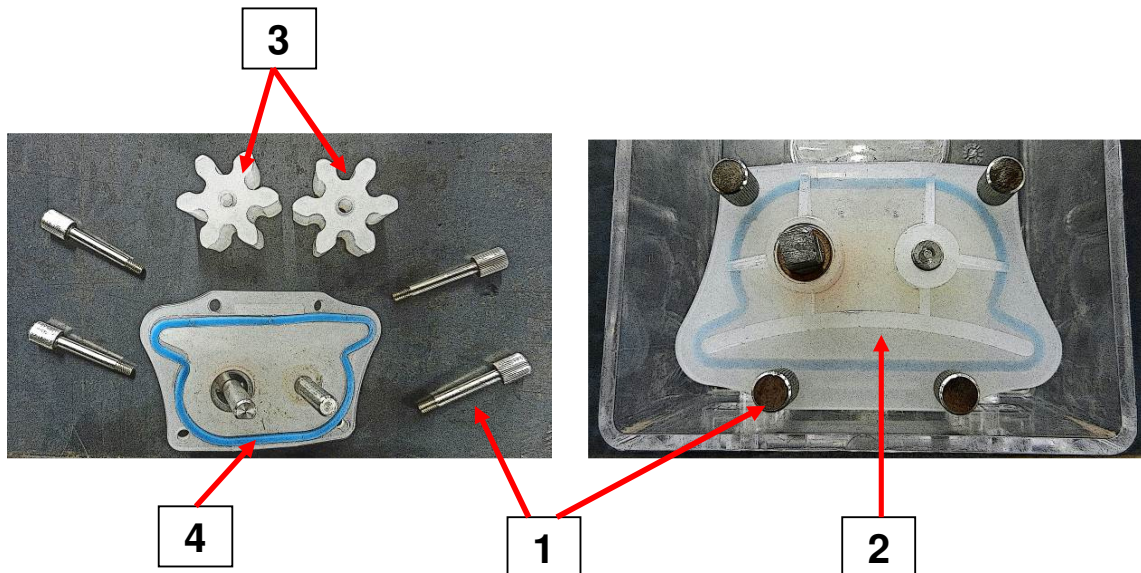

- 5.0 Dismantle the pump chamber components as shown above and wash thoroughly.
- 6.0 Dry the components and reassemble the impellers (3) on the correct spindles with the recessed side facing down.  
**DO NOT USE FORCE**
- 7.0 Replace the impellor unit in the pump chamber ensuring the seal (4) is in place and fasten with the thumb screws (1)  
*These screws should only be finger tight as the use of tools to over tighten could lead to the chamber cover fracturing.*
- 8.0 **Wipe over** all external surfaces with mild detergent/sanitiser and hot water.

**Never immerse the base console in water.**